

❖ P48型尺寸图:

● 插头P48J-Q(R)
P48K-Q(R)

● 直式外型

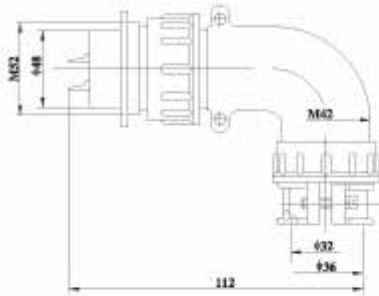
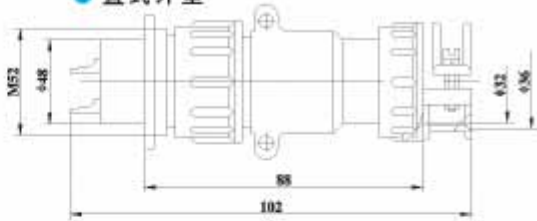

● 安装尺寸

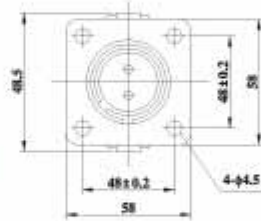
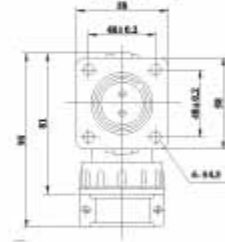
● 插座P48J-A
P48k-A

● 弯式外型

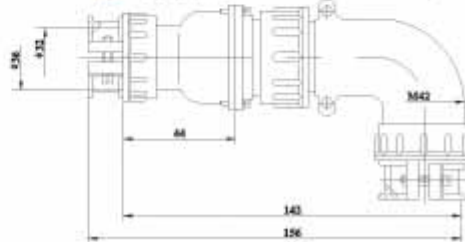

芯数	20芯	26芯
排列图		
组合代号	5	6
额定电流A	10*14 25*6	10
接触对直径、数量	φ1.5*14 φ2.5*6	φ1.5*26
工作电压 (AC.V.rms)	500	500
耐压 (AC.V) 1min	1500	1500
接触电阻mΩ	<3mΩ	<3mΩ
绝缘电阻MΩ	>500MΩ	>500MΩ